

AP MORGAN



Rea Road, Northfield, Birmingham
Offers in the region of £160,000

Features:

- Two double bedroom first floor apartment
- Sought after location
- Lounge/Diner
- Kitchen
- Ensuite shower room
- Bathroom
- Allocated parking space
- EPC - B

Description:

Introducing this attractive two-bedroom apartment nestled in a highly desirable Northfield location, featuring a private ensuite shower room, allocated parking space, and a charming Juliette balcony.

Upon entering, you'll discover two spacious double bedrooms, with the master bedroom boasting its own ensuite shower room. The living space is expansive, with a generously-sized lounge and dining area that opens onto a delightful Juliet balcony, seamlessly connecting to the open-plan kitchen equipped with integrated oven and hob. Completing this inviting space is a well-appointed family bathroom.

The property offers the convenience of a communal car park, ensuring you have your dedicated parking space, and ample visitor parking for guests.

This apartment is perfectly situated for easy access to local shops, with additional shopping opportunities and amenities available in the nearby Longbridge and Northfield town centres. For commuters, Longbridge and Northfield train stations provide direct connections to Birmingham City Centre, while road travel to Birmingham City Centre, the M5, M42 motorways, and beyond is hassle-free from this location. Plus, the area is home to several respected primary schools, secondary schools, and higher education institutions.



Details:

Hall

Lounge/Diner 16' x 11'2" (4.88m x 3.4m)

Kitchen 7'10" x 8'3" (2.4m x 2.51m)

Master Bedroom 10'8" x 9'10" (3.25m x 3m)

Ensuite 2'11" x 9'10" (0.9m x 3m)

Bedroom Two 9'7" x 9'11" (2.92m x 3.02m)

Bathroom 5'5" x 6'5" (1.65m x 1.96m)



EPC Rating: B

Council Tax Band: B (tbc by solicitors).

Tenure: Leasehold (tbc by solicitors).

For more information or to arrange a viewing, please call us on 0121 827 6827.

How can we help you?

Need a mortgage?

We recommend Wiser Mortgage Advice. They will search the market for you to ensure you get the right lender and mortgage deal. They typically achieve mortgage offers much more quickly than if you were dealing with lenders directly.

The initial appointment is free and without obligation. Call us on 0121 827 6827, or visit their website for more information: www.wisermortgageadvice.co.uk

Property to sell?

If you need to sell a property in order to buy, you ideally need to be on the market at least (and preferably Sold STC) before viewing, otherwise you may lose out to other buyers when the right property comes along. In these circumstances we can get your property 'live' quickly. Just book a free valuation and we will visit your property and discuss your needs.

Need a solicitor?

A good solicitor can save you literally weeks of time in the buying/selling process, reducing the stress levels of all involved. We will instruct a reputable firm that is competitive on cost and very reliable. Just ask for a quote.

Need a removal company and storage?

A professional removal company takes the stress out of moving, knowing that your belongings are safe and insured far outweighs any small savings by trying to do it yourself or using a man-and-a-van service. We work closely with and recommend Cube Removals as the leading local firm. For peace of mind and a reliable service call them on 0800 193 0000 or visit their website, cuberemovals.co.uk, to arrange a survey.

FIRST FLOOR
601 sq.ft. (55.8 sq.m.) approx.

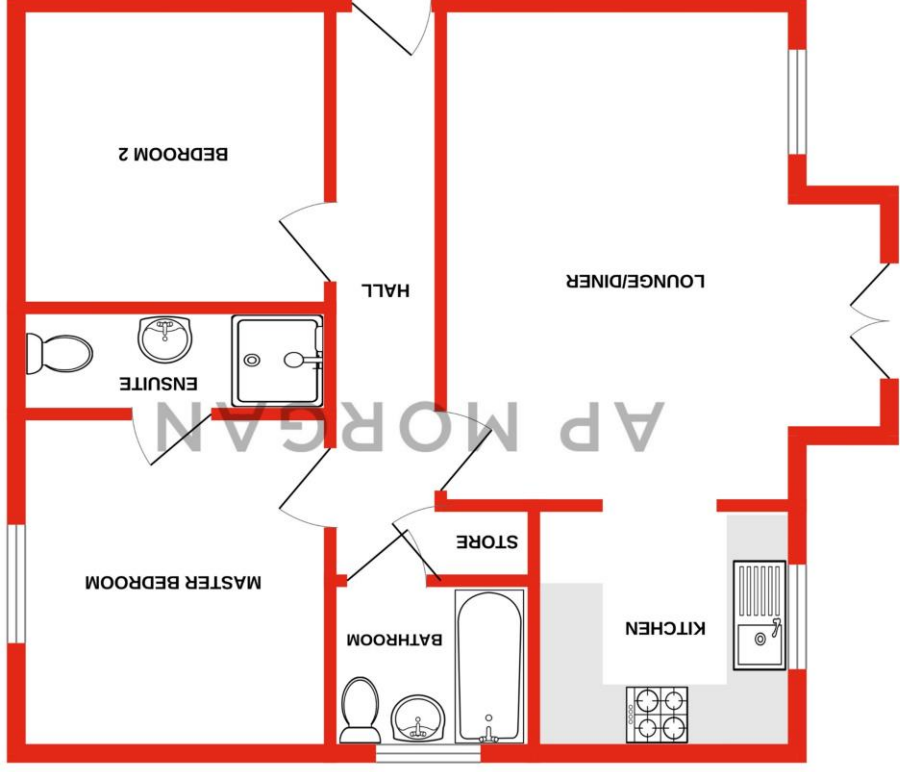

Where every effort has been made to ensure the accuracy of the figures contained here, measurements of doors, windows, rooms and other items are approximate and responsibility is taken for any error. Prospective purchasers: The above figures and appliances shown have not been used and no guarantee as to their operability or efficiency can be given. Made with AutoCAD 2022

No statement in these details is to be relied upon as representation of fact, and purchasers should satisfy themselves by inspection or otherwise as to the accuracy of the statements contained within. These details do not constitute any part of any offer or contract. AP Morgan and their employees and agents do not have any authority to give any warranty or representation whatsoever in respect of this property. These details and all statements herein are provided without any responsibility on the part of AP Morgan or the vendors. Equipment: AP Morgan has not tested the equipment or central heating system mentioned in these particulars and the purchasers are advised to satisfy themselves as to the working order and condition. Measurements: Great care is taken when measuring, but measurements should not be relied upon for ordering carpets, equipment, etc. The Laws of Copyright protect this material. AP Morgan is the Owner of the copyright. This property sheet forms part of our database and is protected by the database right and copyright laws. No unauthorised copying or distribution without permission.